

NVE CHALLENGER SERIES – Fan-Cooled

607 SV Challenger

Heavy Duty Vacuum Pump

Superior Cooling for Extended Use
in Severe Conditions

NEW Design!



*Available in
Hydraulic Drive*

Features

- Side mounted 4-way valve for easy access
- Ideal for trailer mounting



National Vacuum Equipment

2670 Aero Park Drive
Traverse City, MI 49686 USA
800-253-5500 | sales@natvac.com

Arkansas Distribution Center

1612 Warehouse Drive
Fayetteville, AR 72701
479-409-7331, 479-409-6748 | Fax 479-444-8211

NVE CHALLENGER SERIES – Fan-Cooled

Our Challenger Series pumps are designed and built with the customer in mind – resulting in dependable, high performing pumps that are easy to install, operate and service.

- Side mounted 4-way valve for easy access
- Ideal for trailer mounting
- Available in hydraulic drive
- Superior cooling for extended operations in severe conditions
- Heavy duty roller bearings
- Slotted end plate bolt holes for crash protection
- Precision-pinned end plates
- 4-point oiling system
- Vane wear inspection port
- Exhaust gas temperature gauge
- Diesel flush port
- High-strength ductile iron housing
- Built and supported in the USA

607 SV Challenger

Dimensions: 29.9" W x 28.9" L x 15.2" H
Weight: 395 Lbs.

Model #100-607A-FS

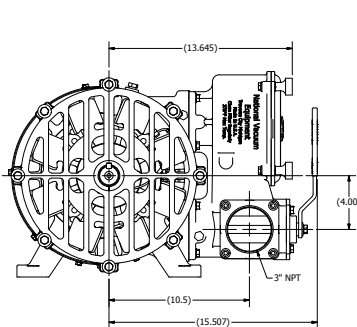

(.375) SQ
(1.662) (R.750)
SECTION J-J
SCALE 1 / 4

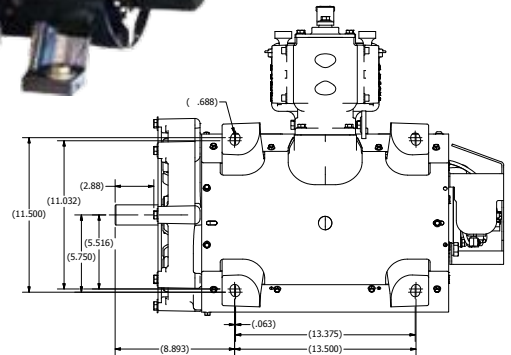
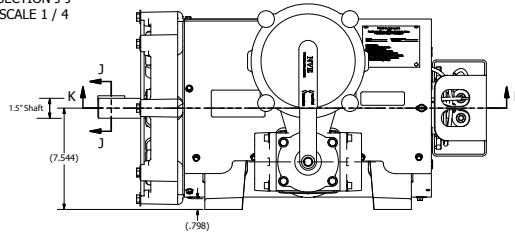

RPM		Pressure (PSI)				Free flow	Vacuum (inches of Mercury)					
		20	15	10	5	0	5	10	15	20	25	27
1500	Hp.	34	32	29	27	23	23	22	21	20	19	19
	CFM	282	291	301	331	357	348	338	331	310	282	244
1250	Hp.	29	27	24	23	20	20	19	16	15	14	14
	CFM	229	237	244	269	290	282	275	269	252	229	198
1000	Hp.	25	23	20	18	15	15	14	14	13	12	12
	CFM	178	184	190	209	226	220	214	209	196	178	155



All specifications subject to change without notice.

Recommended Setup for Optimum performance 1250 RPM

1500 RPM Intermittent Operation Only

National Vacuum Equipment

2670 Aero Park Drive
Traverse City, MI 49686 USA
800-253-5500 | sales@natvac.com

Arkansas Distribution Center

1612 Warehouse Drive
Fayetteville, AR 72701
479-409-7331, 479-409-6748 | Fax 479-444-8211